

# TROPF-BLUMAT INTELLIGENT WATERING

## Thank you for choosing a Tropf-Blumat watering system.

Tropf-Blumat is a fully automatic watering system that works without electricity and electronics. The great advantage of Tropf-Blumat is that every single plant is watered individually!

**This ensures better growth and a lower water consumption.**

The installation is explained step by step in these operating instructions. Further tips and tricks can be found on our homepage.

*Have fun with your plants and your watering system!*

### Intended use:

Drip watering for outdoor plants.

### Recommended application areas:

Plants on terraces, balconies, in greenhouses, polytunnel, raised bed.

### For all plants:

The Tropf-Blumat system can be used to water fruit and vegetables without any worries. All products have been tested in accordance with the Austrian drinking water directive and are well below all specified limits. All Tropf-Blumat products are free from BPA and phthalates.

### Smart & simple:

The plants control the watering, no timer, no app. We believe it is even better than any app. Lean back and relax, your friends will send you beautiful photos of the plants.

### Sustainability:

See for yourself. Tropf-Blumat needs no electricity and only consumes water as required. The plastic parts have UV-protection to prolong their useful lives. All components can be purchased and replaced individually.

### Warranty:

We want you to be satisfied. All Blumat products are covered by a 3-year warranty from the date of purchase. Should you not be entirely satisfied, please contact your retailer or us directly (info@blumat.at).

**Quality Made in Austria.**

The Blumat logo, featuring a stylized crown icon to the left of the word "Blumat" in a bold, sans-serif font.

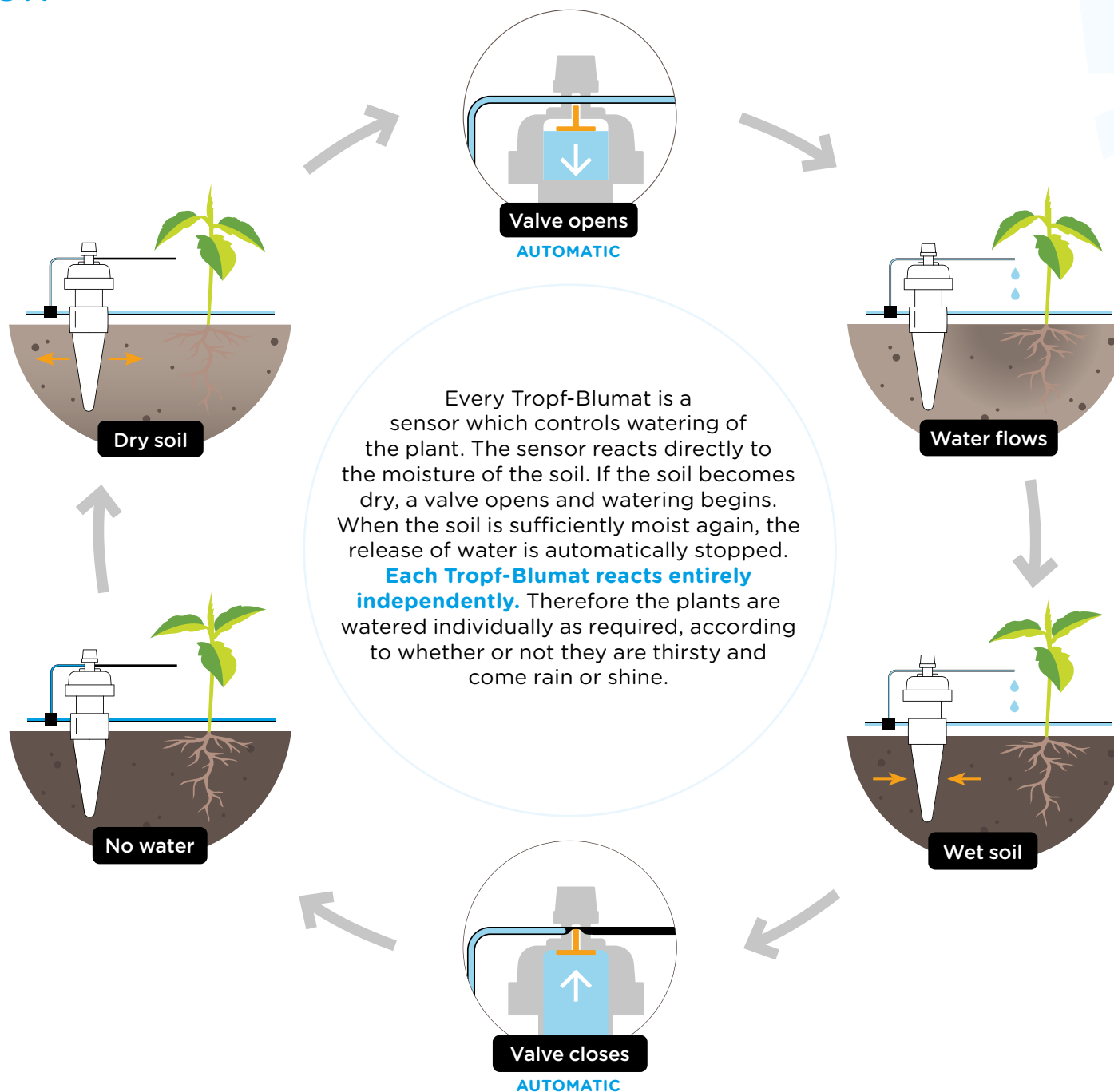

## WATER CONNECTOR - OPTION A

- PRESSURE REDUCER**
- Connect the pressure reducer to a water tap or a pump with a compensation vessel.
  - The pressure is regulated constantly to 1 bar.
  - The plants may be standing up to 4 metres higher or 3 metres lower.
  - Up to 250 Tropf-Blumat sensors can be supplied by one pressure reducer.

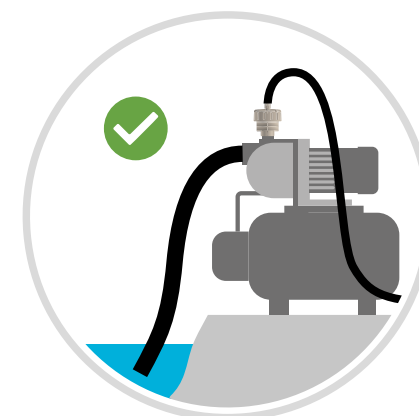
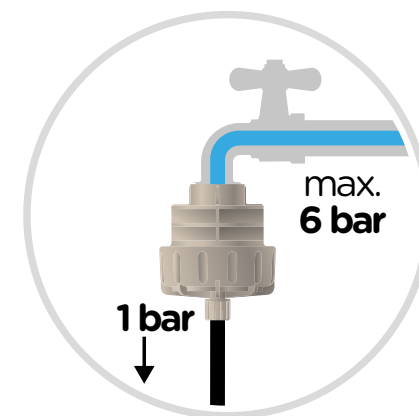
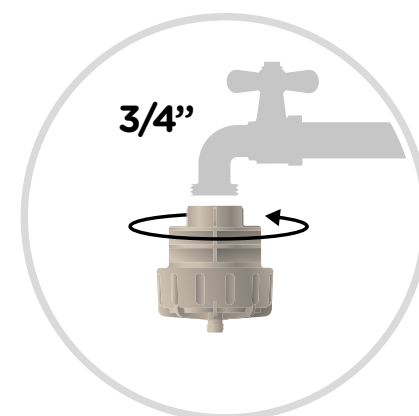
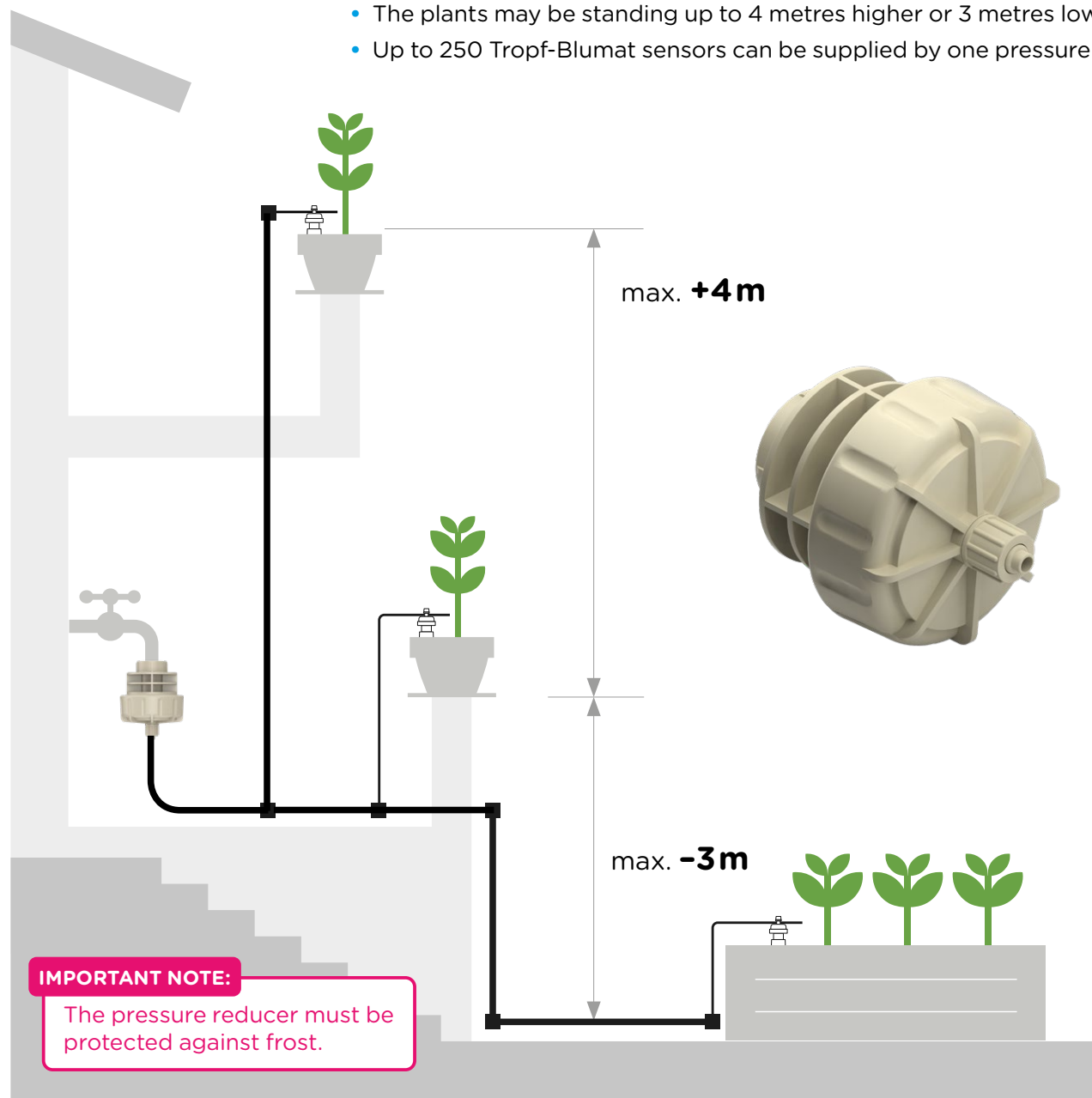

## WATER CONNECTOR - OPTION B

### TANK CONNECTOR

- Fit the tank connector to any container. To do this, drill a hole with a diameter of 12 mm.
- The tank must always be higher than the plants (water level at least 0.5 m and max. 14 metres higher).
- Fit the tank filter additionally, especially when using rain water.

**Our recommendation:** The water level should be at least 1 metre above the sensors.

**TIP:** An opaque tank with lid reduces the growth of algae.

**TIP:** Install a shut-off valve in the feeding tube after the tank connector. This makes it easier to set and clean the tank later.

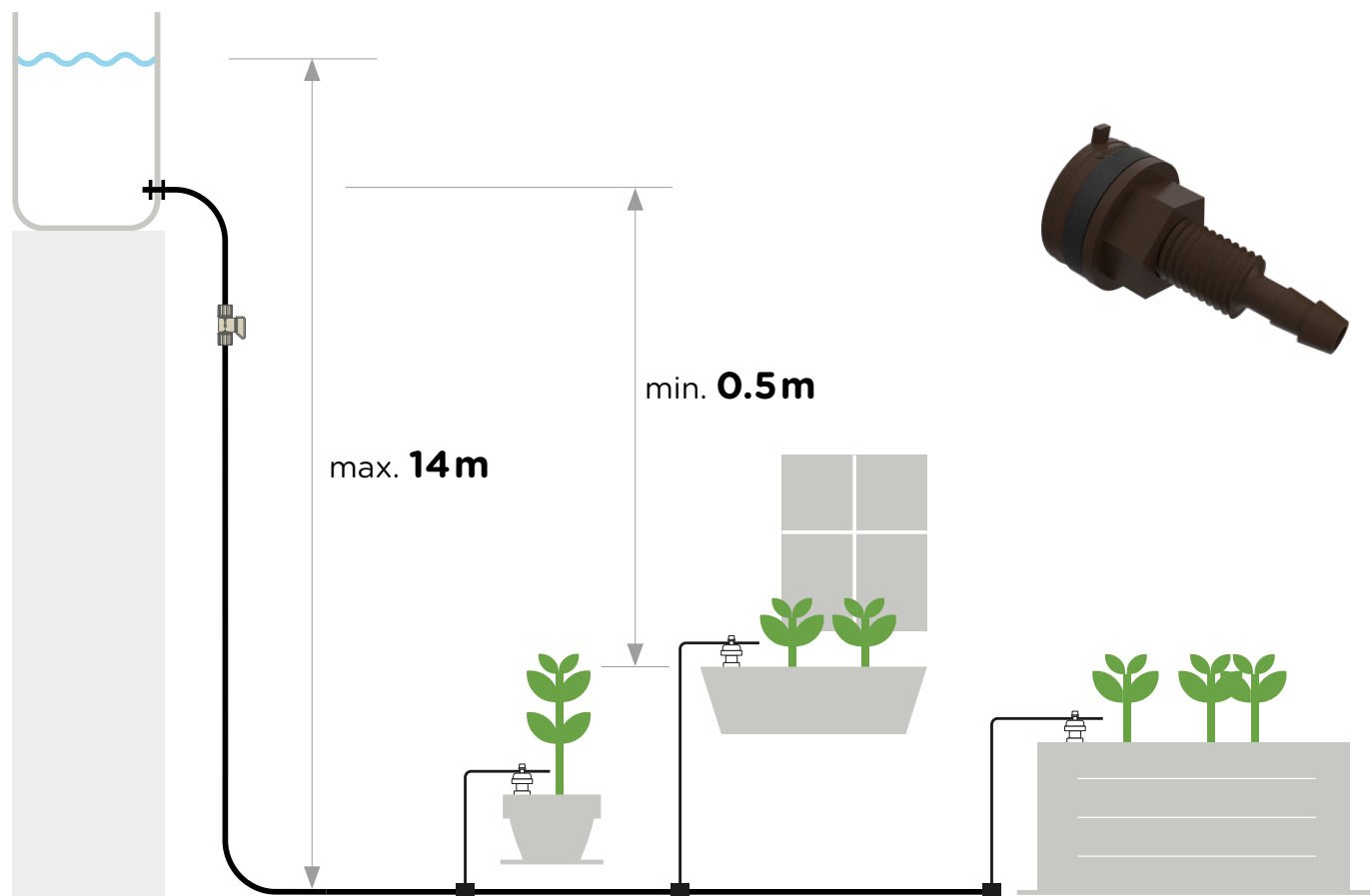

## LAYING THE FEEDING TUBE

- Lay the feeding tube from the pressure reducer/tank to the plants.
- The feeding tube is easier to lay when you heat it up (warm water, sun) prior to assembly. Do not kink the tube!
- Cut the tube through and insert a T-piece **1** for every tube. Use an end-piece **2** at the end of the system.
- Always push on the tubes completely **3**
- The pre-assembled drip tubes in the set can also be left on the T-piece/end-piece for first-time assembly.

**Info:** The feeding tube is not suitable for direct laying in the soil or in walls. Use an empty conduit in this case; joints must remain accessible.

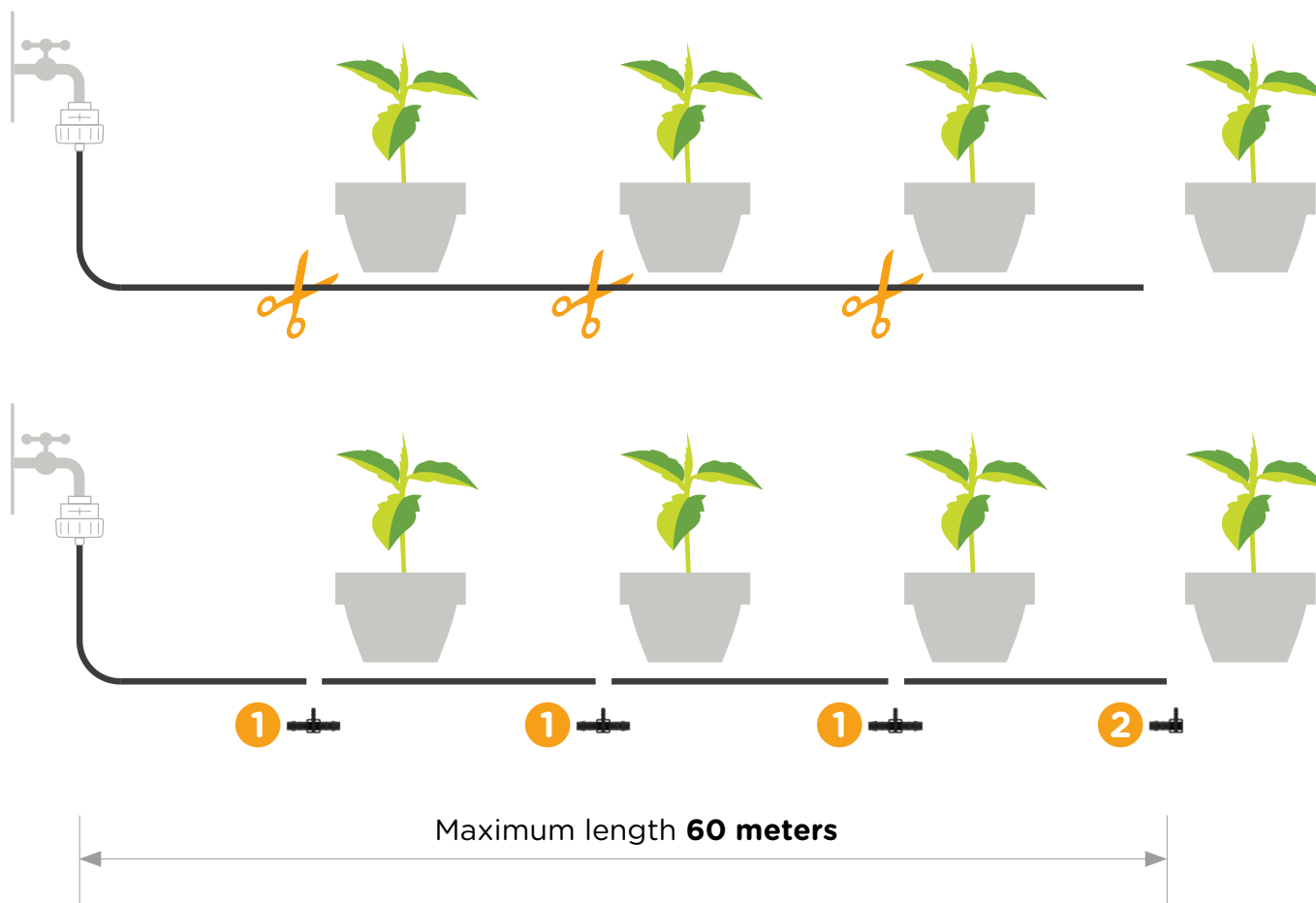

### IMPORTANT NOTE:

Do not use a lubricant (grease, soap, etc.) for pushing on! This will damage the tube.

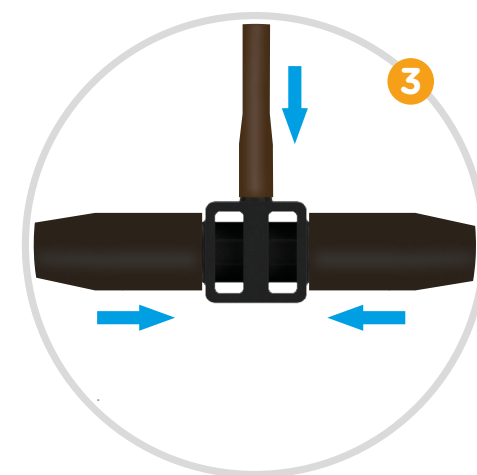

## REQUIREMENT / PLANNING

- Install at least one Tropf-Blumat per plant or pot.
- 1 Tropf-Blumat will water a radius of about 20-25 cm of soil.

**Info:** Watering takes place through the thin drip tube and not through the clay cone. The clay cone and the water in it serve only to control the watering.

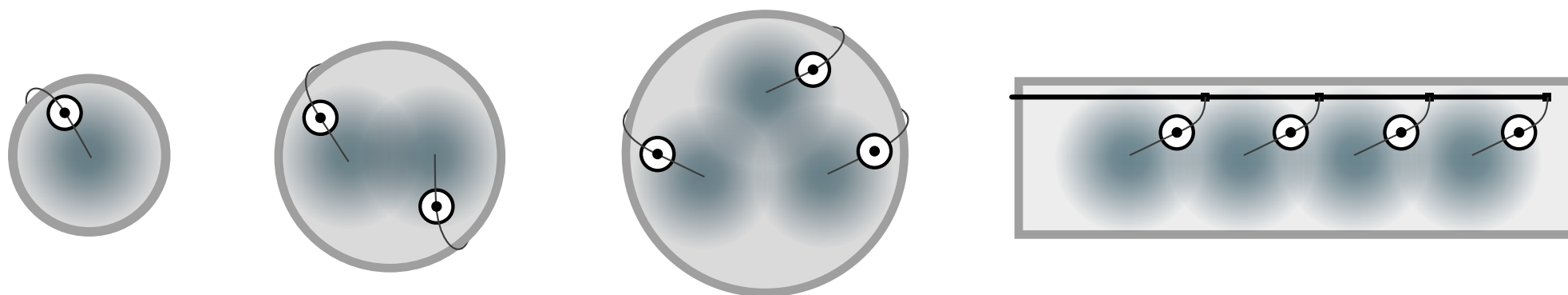
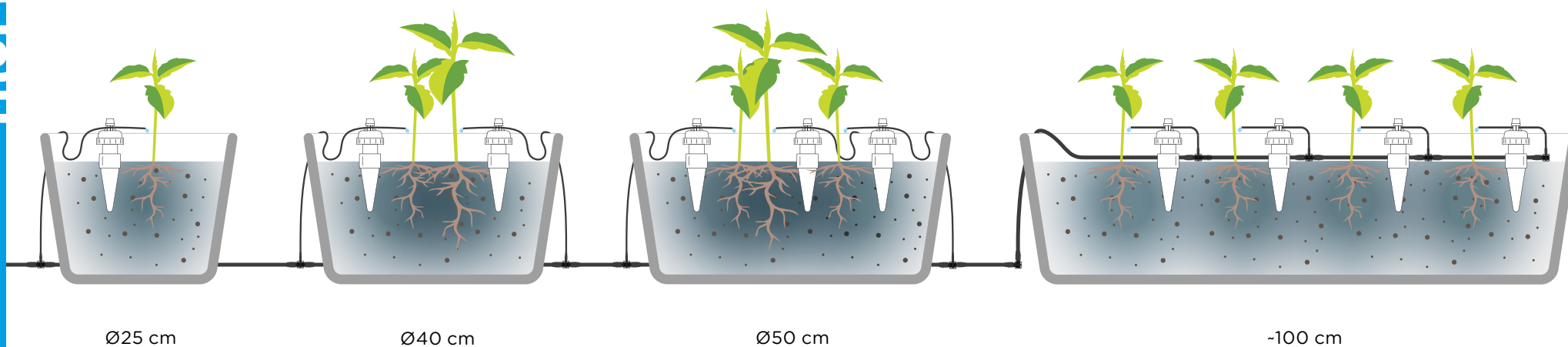

● Tropf-Blumat    — Feeding Tube    — Drip Tube

# ASSEMBLING THE TROPF-BLUMAT SENSORS

1.

Unscrew the top parts and screw them back together underwater. Every Tropf-Blumat (sensor) must be filled completely with water.

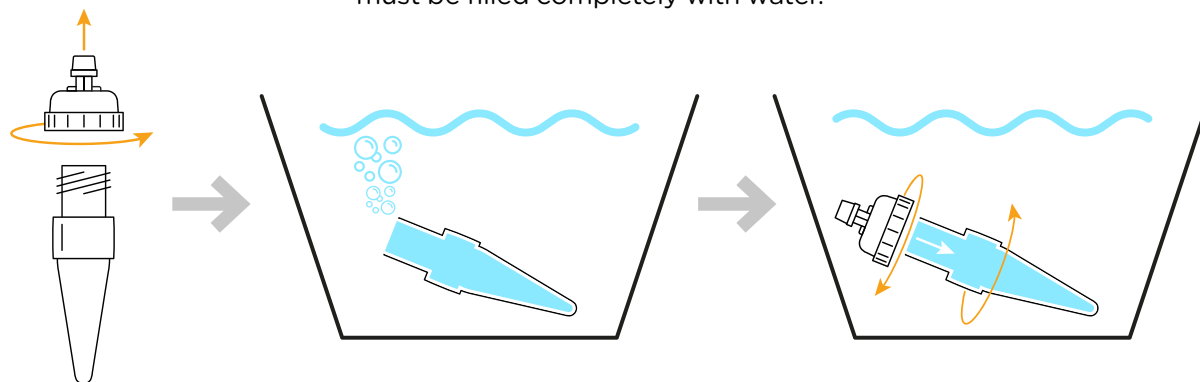

2.

Leave the sensors **filled with water and screwed together** in the water for at least 15 minutes.

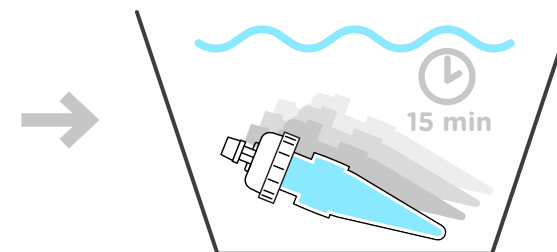

3.

This step is particularly important. Water the soil in all plant pots thoroughly several times **before** further assembly.

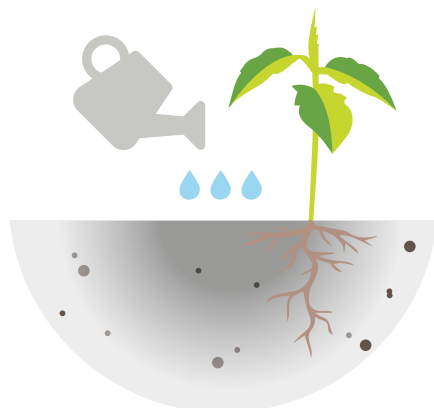

4.

Stick a Tropf-Blumat into the moist soil next to every plant (approx. 10-15 cm away from the plant). The clay cone must be covered completely by soil, press down loose soil.

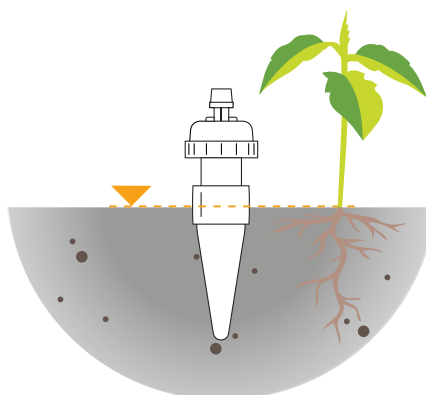

5.

Connect the flexible drip tube to the T-piece or the end-piece and push it through the Tropf-Blumat. The end must protrude approx. 8 cm out of the Tropf-Blumat and should be near to the plant. Finally tighten the setting screws.

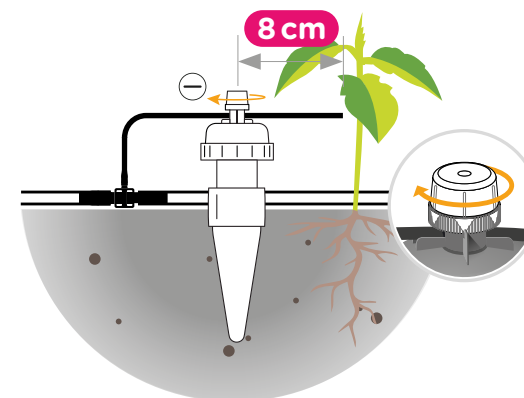

## SETTING

- Turn on the water tap and check that all the sensors are “closed”. There must be no drips coming from anywhere! If necessary, tighten the setting screw further.
- Begin with the setting at the last Tropf-Blumat in the system so that the system is vented.

1.

Turn open the setting screw in anticlockwise direction until water runs out of the drip tube.

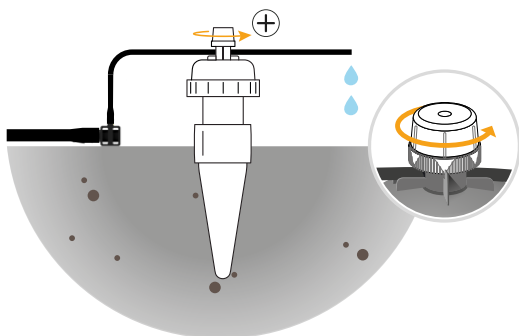

2.

Close the setting screw again slowly until no more water emerges. Just one drop of water should remain on the drip tube.

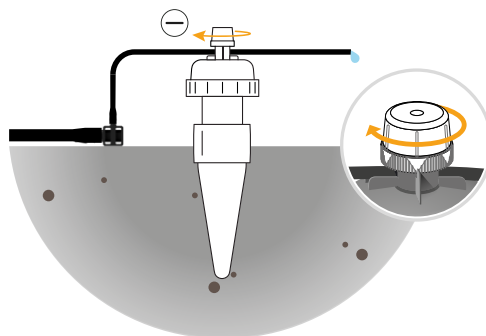

3.

Finally close the setting screw another 1/4 turn (2 marking arrows).

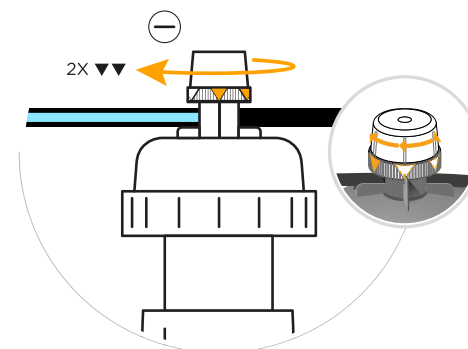

**Ready!** Since the soil is moist, the Tropf-Blumat may not discharge any water. Watering does not begin until the soil is dry. Now make the setting for every single Tropf-Blumat.

## CHECKS

- Check the water discharge for several days after installation. Readjust, if necessary by turning open (= more water) or close (= less water). Adjust carefully, 1/2 an arrow will usually suffice.
- **Do not let a dry soil surface fool you.** The water spreads out underground. In most cases, only the area under the drip tube is visibly moist.
- **Always leave the tap open/refill the water tank in time.** Even in rainy weather. If the water supply is cut off for any length of time, the roots draw the water out of the Tropf-Blumat. A Tropf-Blumat that is not filled with water does not work!

## TROPF-BLUMAT MAXI

The Tropf-Blumat Maxi is ideal for watering plants in large pots and tubs from a container height of 30 cm. It ensures even moisture in the roots area but the surface tends to remain dry.

It is assembled and set in exactly the same way as the normal Tropf-Blumat (pages 6-7). The following should be noted additionally for the Tropf-Blumat Maxi.

- Water the soil thoroughly half an hour before assembly so that the moisture is distributed well in the whole container.
- Stick the Tropf-Blumat Maxi into the soil (not in the root ball of fresh plants), then press down the soil lightly.
- Dig a hole in case of dense rooting or in very hard soil. Fill up the hole halfway with loose soil and stick in the Tropf-Blumat Maxi. Then water thoroughly and fill up the rest of the hole with soil.

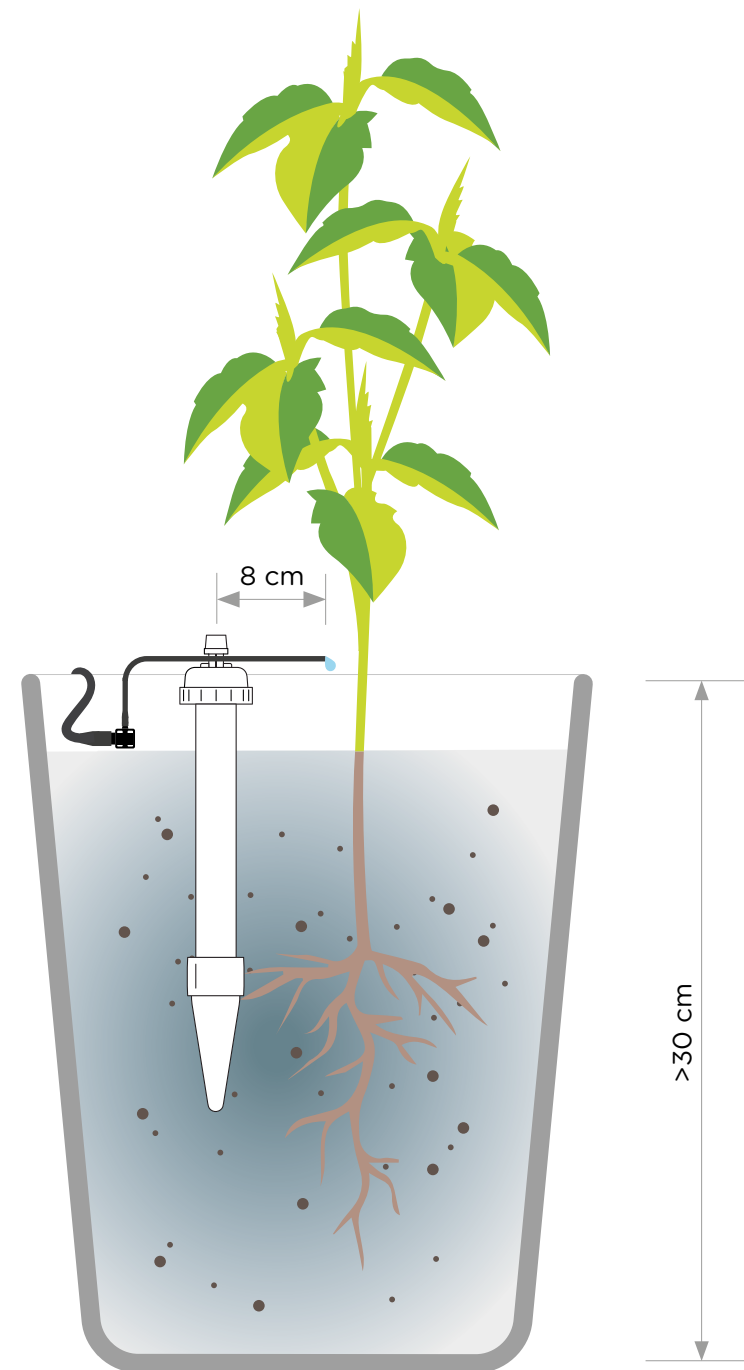

## USE OF DISTRIBUTION DRIPPERS

With the Blumat distribution drippers, you can increase the number of drip points per Tropf-Blumat to up to 5. This achieves a more even water distribution in larger containers.

- Cut off approx. 20 cm-long pieces from the thin drip tube and connect up to 5 distribution drippers with each other. Use an end distribution dripper at the end.
- The **first distribution dripper must be 8 cm away from the Tropf-Blumat**. Position the other distribution drippers anywhere in the root area of the plants.
- Now set the Tropf-Blumat as usual. **Only then connect the distribution drippers with the Tropf-Blumat.**
- The black screw must not be adjusted. Unscrew completely and clean once a year or as required

**Our recommendation:** When using distribution drippers with a tank, this should be at least 2 metres higher.

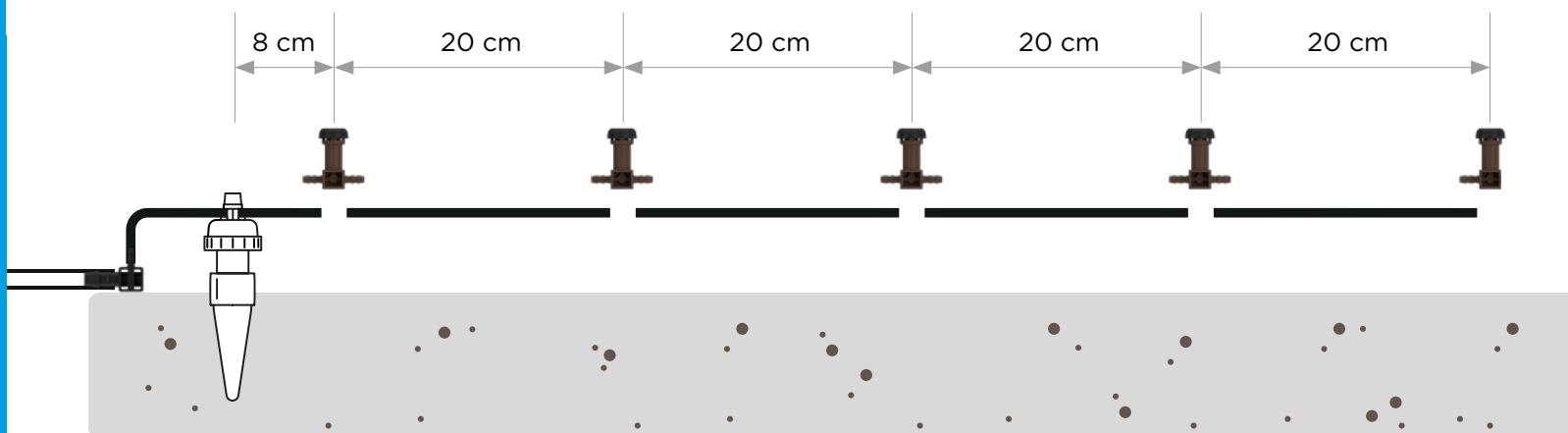

### TIP:

Use distribution drippers with the Blumat supports. This prevents roots from growing in.



## WHAT SHOULD I DO IF...

FURTHER TIPS AND ADVICE CAN BE FOUND ON OUR HOMEPAGE:



	Error sources	Error correction
... THERE IS NO WATER IN THE SENSOR?	If the water supply is interrupted (water tap turned off, tank empty, hose kinked) or the setting screw is too tight, watering ceases. The sensor empties after a certain time (depending on the plant, temperature, precipitation). A Tropf-Blumat that is not filled with water does not work!	Refill the Tropf-Blumat with water and reset it.
... THE TROPF-BLUMAT DOESN'T CUT OUT?	The Tropf-Blumat closes slower than usual at below 5°C (cool nights in the autumn).	Close the adjustment screw down by 1/2 to 1 marking arrows.
... THERE IS NO WATER COMING OUT OF THE DRIP TUBE?	The drip tube may be stuck together close to the valve after a long time in storage or just after purchasing. That's no problem.	Pull the tube out of the Tropf-Blumat slightly and rub the stuck part between your fingers.
... THE DRIP TUBE IS TOO SHORT?	The water reaches the sensor too quickly; watering is shorter and less.  *This setting may be desirable for plants that require little water.	Lengthen the drip tube to 8 cm.
... THE DRIP TUBE IS TOO LONG?	The water reaches the sensor too late; watering is long with a lot of water.  *This setting may be desirable for plants that require a lot of water. <b>Attention:</b> If the drip tube is too long, watering does not stop!	Shorten the drip tube to 8 cm.

## OVERWINTERING AND CARE

Empty the tank before winter and remove the pressure reducer. Clean the inside and outside of all sensors with water; encrustations on the clay cone can be rubbed off with sandpaper. The tubes can be left outside; store the pressure reducers and sensors where they are protected from frost.

## THE NEXT SEASON

Fill the sensors, stick them in the moist soil and reset. Check the tubes for leaks (especially at the joints). Extend the system if necessary. The connectors of T-pieces and end-pieces that are not needed can simply be plugged (see Accessories).

## YEAR-ROUND OPERATION

Operation all year-round is possible in regions without frost. The sensors gradually lose a little water and must be filled up in good time. Check the water level in the Tropf-Blumat after about 6 to 8 months and fill up, if necessary.

## FERTILISATION

Long-term fertilisers are recommended which are best worked into the area around the drip point. You can also add fertiliser using the watering can of course.

## IMPORTANT NOTE:

The Tropf-Blumat watering system has been specially developed for outdoor plants and may **not be used indoors**. Protect plants from falling over and do not place on moisture-sensitive surfaces. Avoid damage (e.g. dripping into cellar rooms) from any water spillage

## PRODUCT RANGE

With a Tropf-Blumat set you receive a ready to connect, fully automatic watering system. You can add to and extend these almost as you wish with the accessories.

### SET40

For 40 plants, including pressure reducer



### SET12

For 12 plants, including tank connector



### Tropf-Blumat

Watering sensor

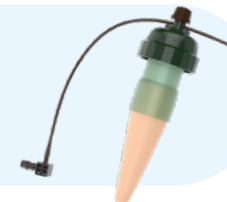

### Tropf-Blumat Maxi

Watering sensor for large plants



### Pressure reducer

Outlet pressure 1 bar, for 3/4" tap



### Tank connector

For installation on any tank, borehole 12 mm



### Water filter

Fits the tank connector



### Feeding hose 8 mm

Available in black and white



### Shut-off valve

For the 8 mm feeding tube



### Drip tube 3 mm

Flexible feeding and for connection of distribution drippers



### Distribution dripper

To connect to a Tropf-Blumat



### Hose security clamp

For all 8 and 3 mm tubes



### Support

For 8 mm feeding tube and distribution drippers



### Hose union 8-8 mm

To connect feeding tubes



### Elbow 8-8 mm

To change the direction of feeding tubes



### Tee 8-8-8 mm

To divert feeding tubes



### T-piece 8-3-8 mm

To connect a Tropf-Blumat



### End-piece 8-3 mm

To connect a Tropf-Blumat at the tube end



### Mini-tee and hose union

For branching and connecting 3 mm drip tubes

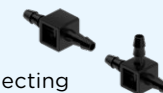

### Stopper

To close 3 mm outflows (T-piece, end-piece, distribution dripper)



### Protection cap

Prevents accidentally moving the Tropf-Blumat



### Corer

For easier insertion of the Maxi and Digital



### Blumat Digital

Professional checking of the soil moisture level



## Automatic water dispenser BLUMAT CLASSIC

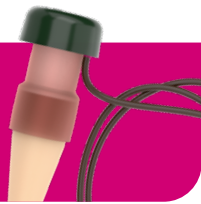

### Ideal for indoor plants

- Fast, easy assembly.
- The plants stay in their normal positions.
- No repotting necessary.
- Fully automatic and requirement-based.
- At the weekend, on holiday, all year round.

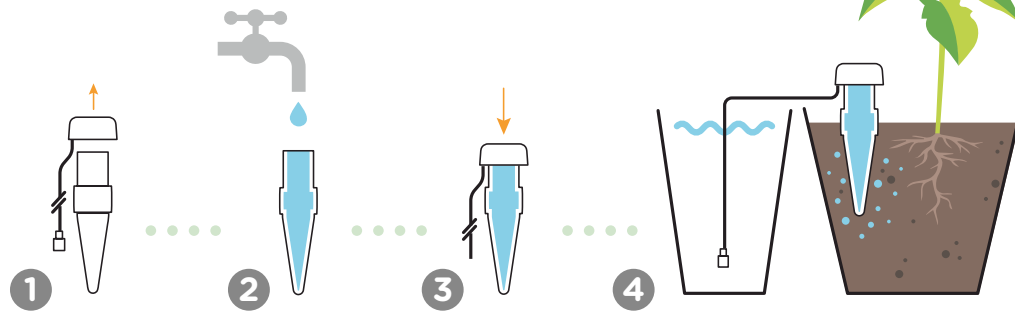

also in **XL**  
version

Classic XL



Blumat Classic » Approx. 75 ml / 24 h

Blumat Classic XL » Approx. 125 ml / 24 h

Blumat Classic is the reliable watering system for indoor plants. The water is sucked out of any container and distributed into the soil via the clay cone.

This works automatically; the plants take what they need. Also suitable for the watering of balcony plants when you're on holiday in the XL version.

## BLUMAT EASY Universal bottle adapter



Blumat Easy is the easy way to water plants on balconies and terraces; also for indoor plants of course. Easy fits onto almost all commercially available 0.5 to 1 l plastic bottles. Stick the filled bottle into the soil with the clay cone, bore a hole in the bottle and the water will be dispensed to the plant for several days.

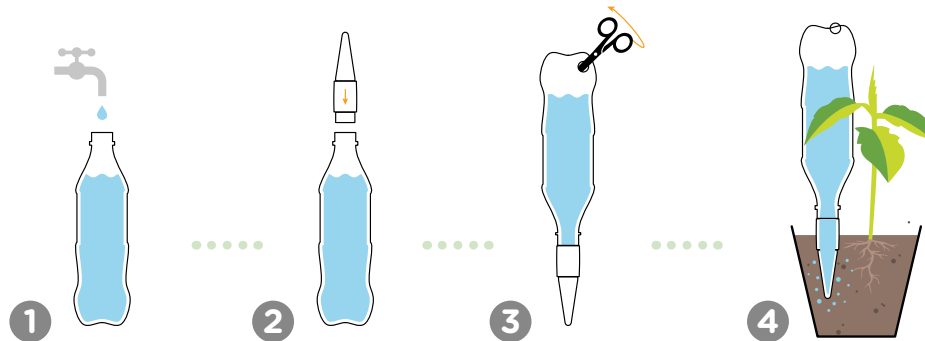

Blumat Easy » Approx. 200 ml / 24 h

Blumat Easy XL » Approx. 300 ml / 24 h

also in **XL**  
version

Easy XL



**Info:** Blumat Classic and Blumat Easy can be used to water fruit and vegetables without any worries. The products are tested according to strict standards and are free from BPA, PFAS and phthalates.

*video guides* →

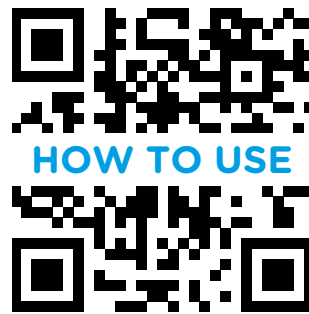

 **blumat.com**